



### Heater Hardline Adapter kit for 7.3L Ford 300-901

QTY	DESCRIPTION
1	Tube Assembly
1	Retainer Plate
1	O-ring - 2-016
1	NPT Adapter - 3/4-14
1	Socket Head Cap screw - M6 X 1.0 X 18
1	Hex Head Flange Bolt - M6 X 1.0 X 12

If no heater will be used, Holley P/N 97-425 will provide the application specific components to block off the below heater ports.

**NOTE:** The 300-901 heater line adapter will work with either the original Ford or Holley intakes.

1. Before installation remove the original top heater tube from the top front of the engine block.
2. Lube all O-ring surfaces and install the heater hardline as shown below.

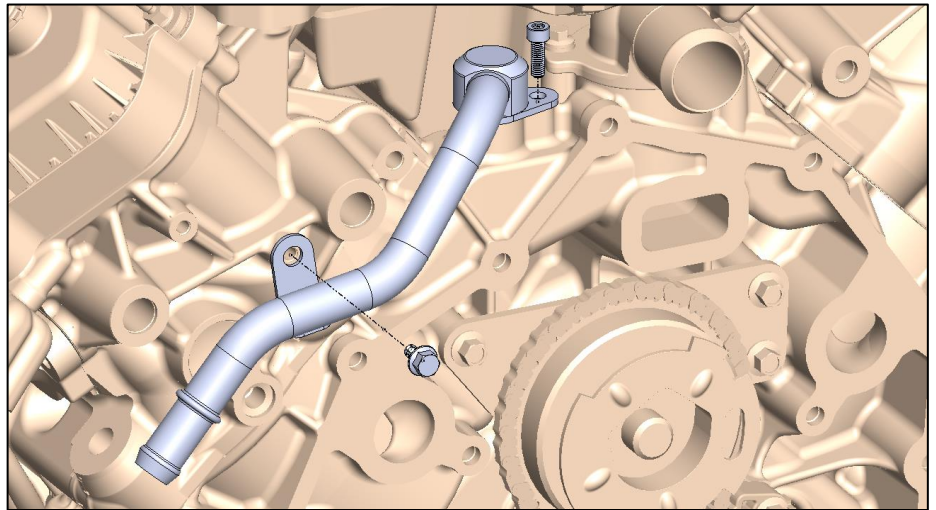
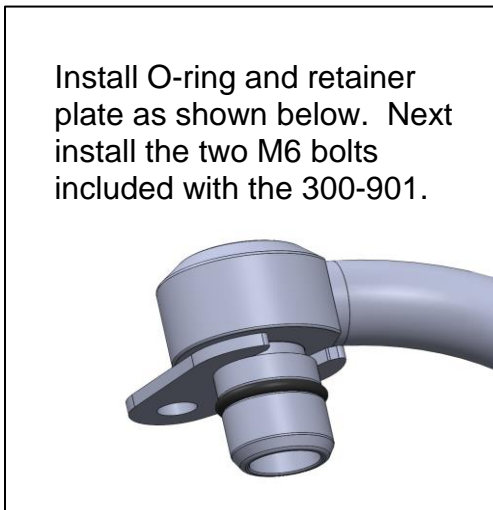

**NOTE:** Torque M6 bolts to 85 in./lbs

3. Install the NPT adapter as shown below.

**NOTE:** On all NPT adapters, use thread sealant (Loctite® brand 567 pipe thread sealant or equivalent). Install to finger tight, and then tighten 2 to 3 rounds.

**WARNING:** Loosening NPT fittings after installation can cause leaks. Do not rotate past final orientation.

